

**CARMACKS
Map 3**

**CARMACKS
Map 4**

**CARMACKS
Map 2**

**CARMACKS
Map 1**

**For Detail, please see
CARMACKS maps 2a & 2b**

**VILLAGE of CARMACKS
Map Index**



Yukon

Energy, Mines & Resources
Sustainable Development Division
Land Planning Branch

db June, 2010

10
54038

115101-051

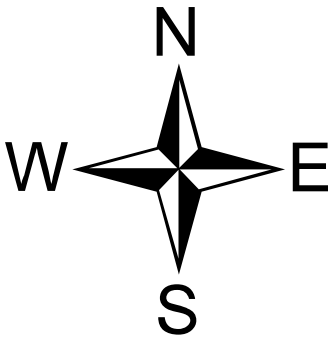
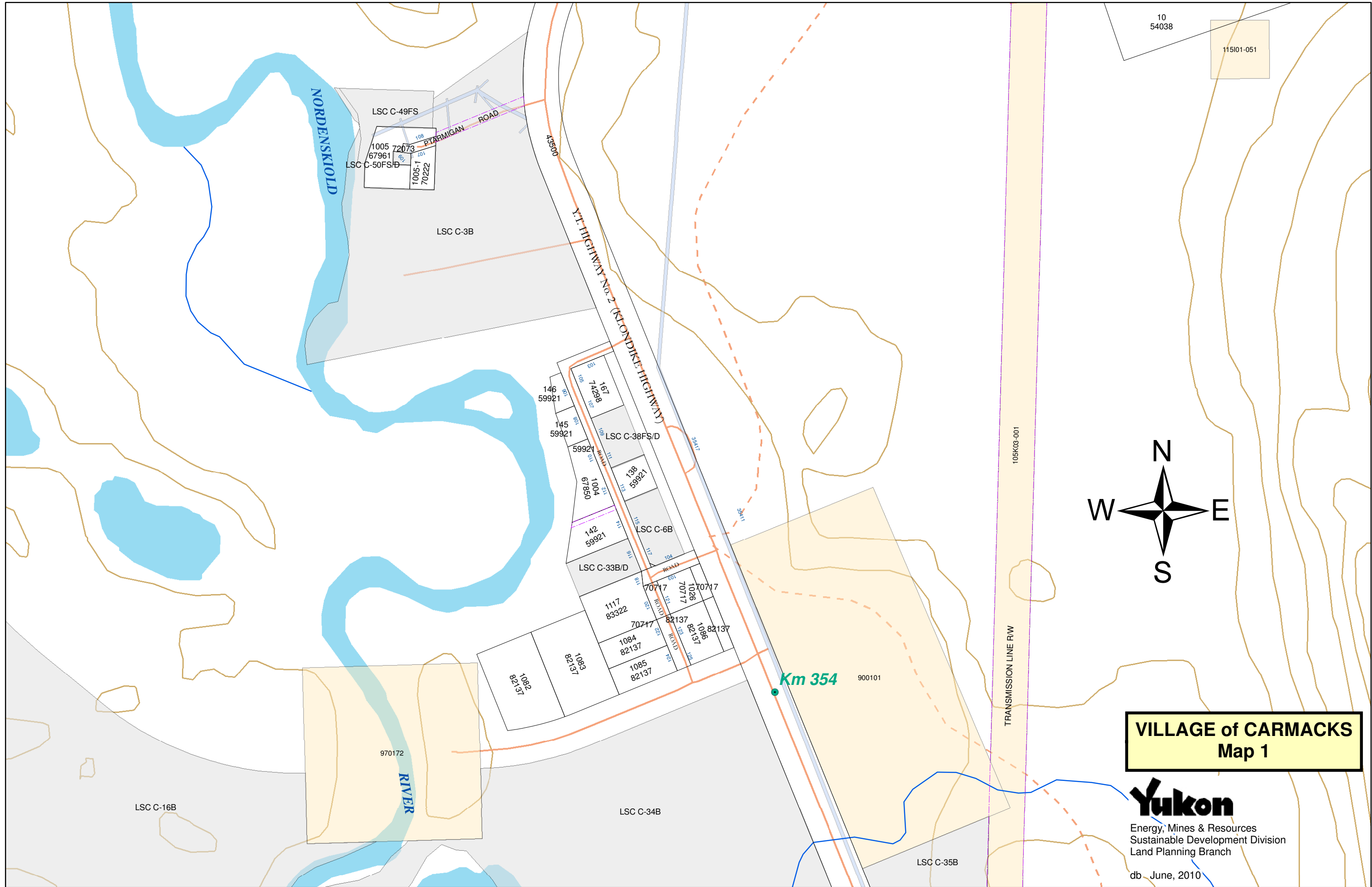

VILLAGE of CARMACKS
Map 1

Yukon
 Energy, Mines & Resources
 Sustainable Development Division
 Land Planning Branch

db June, 2010

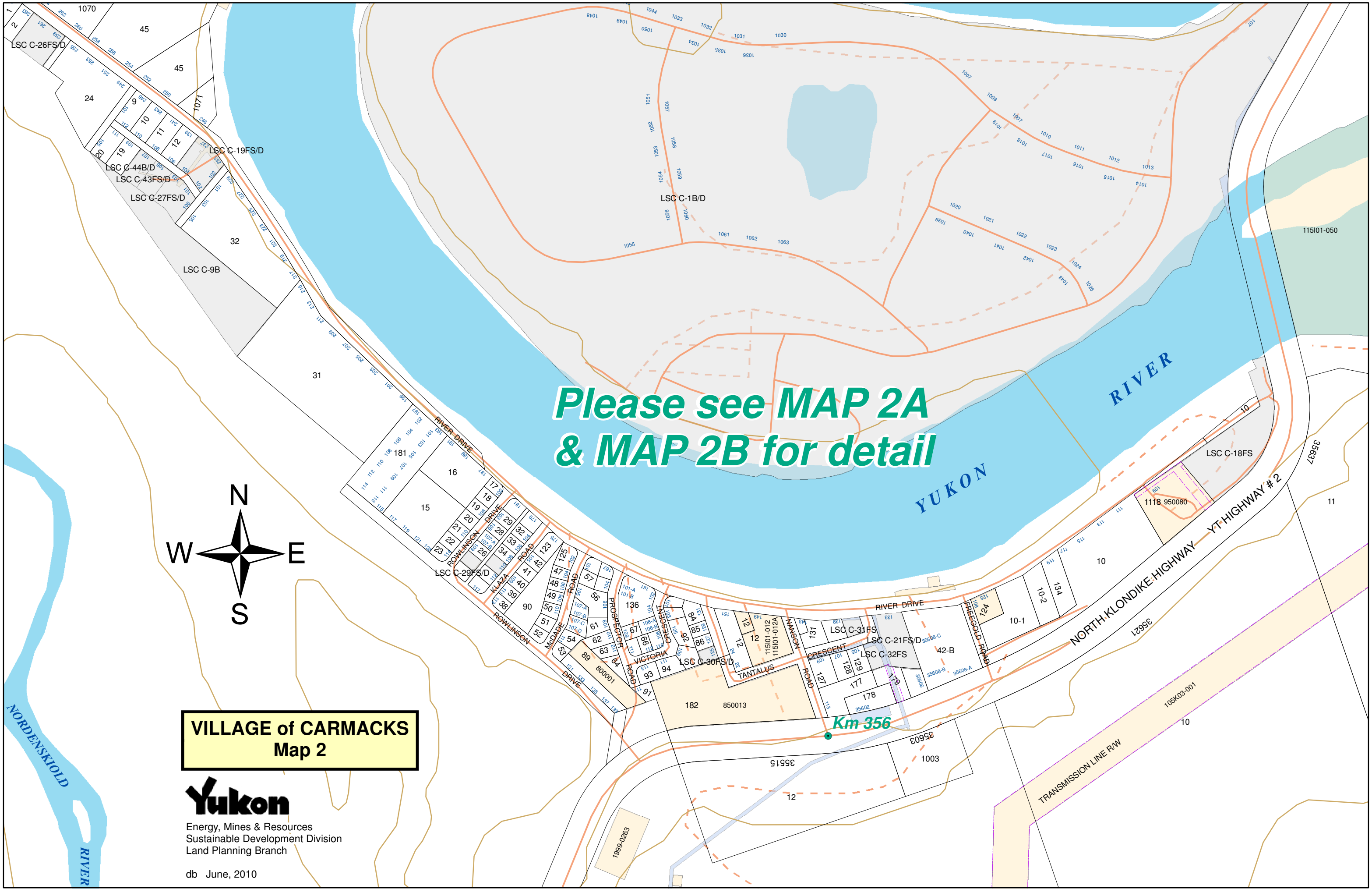

**Please see MAP 2A
& MAP 2B for detail**

**VILLAGE of CARMACKS
Map 2**

Yukon
Energy, Mines & Resources
Sustainable Development Division
Land Planning Branch
db June, 2010

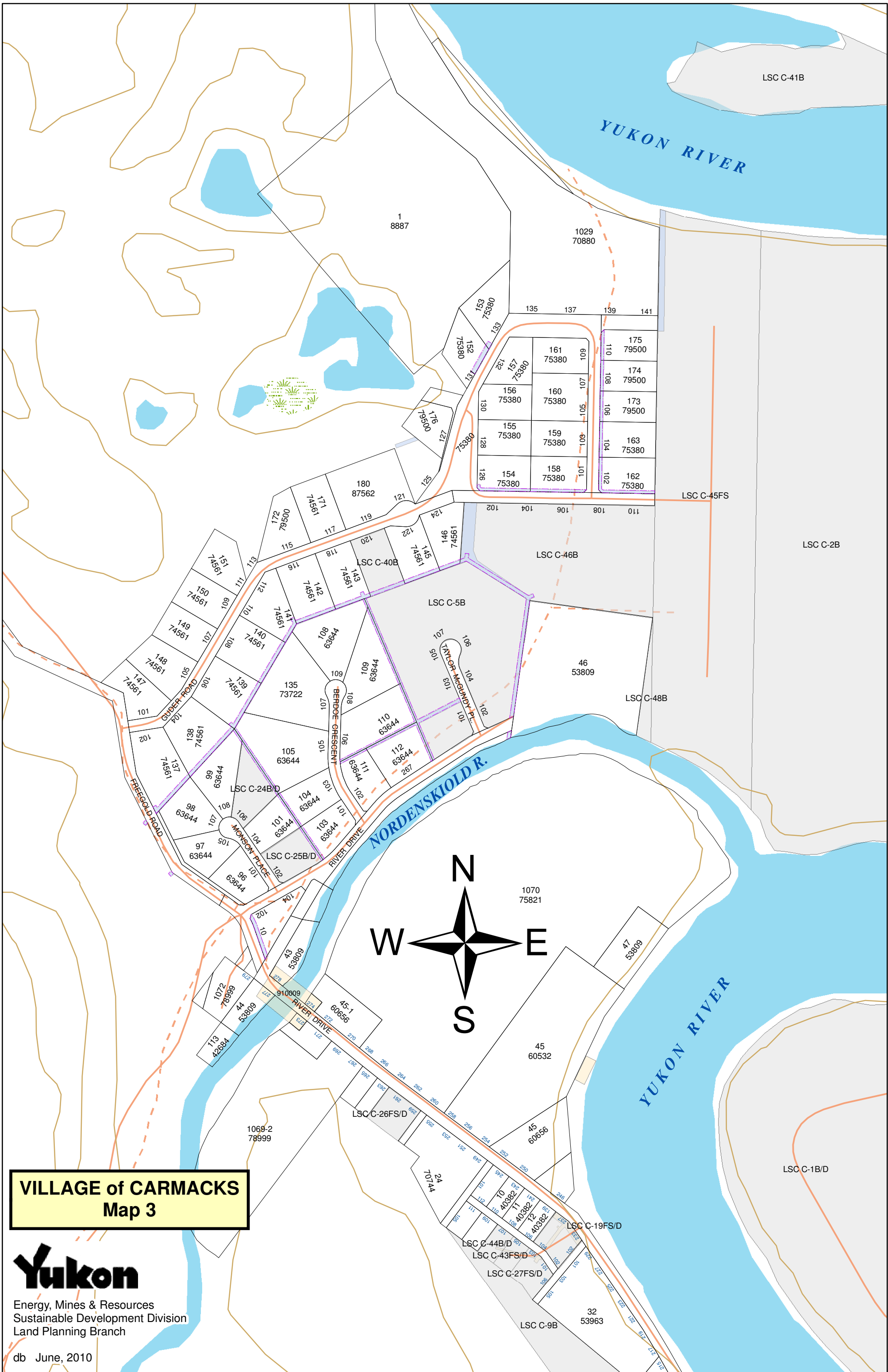

VILLAGE of CARMACKS
Map 3



Energy, Mines & Resources
 Sustainable Development Division
 Land Planning Branch

db June, 2010

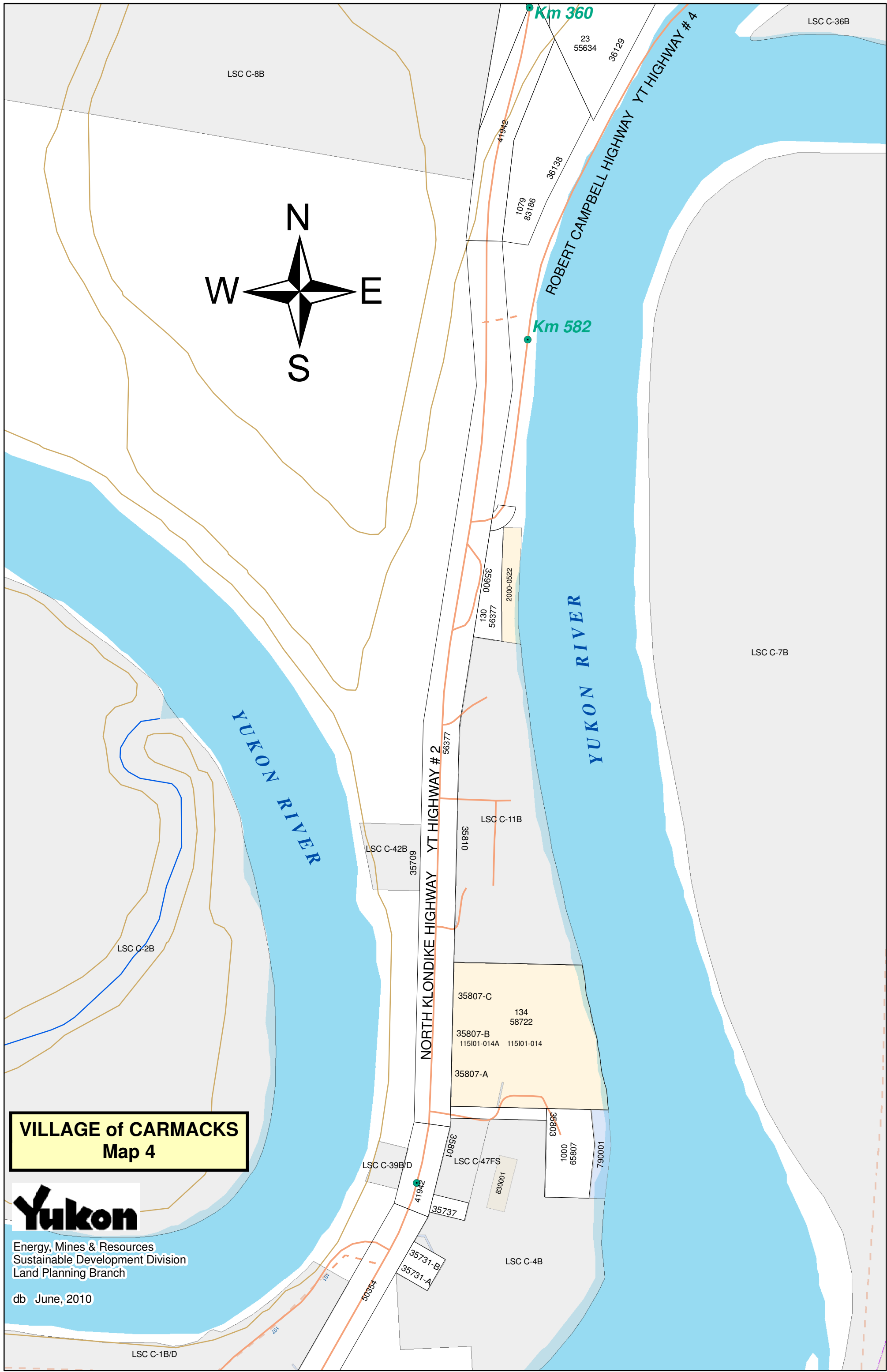

LSC C-8B

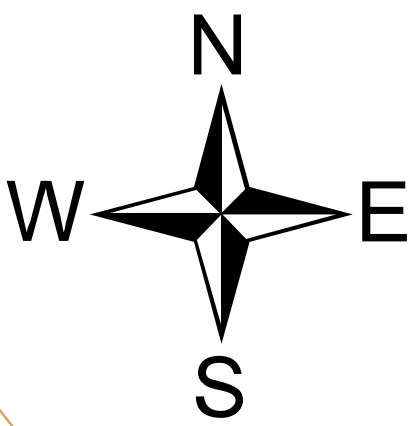

Km 360

23
55634

36129

LSC C-36B

41942

1079
83186

36138

ROBERT CAMPBELL HIGHWAY YT HIGHWAY # 4

Km 582

0069C

130
56377

2000-0522

LSC C-7B

YUKON RIVER

YUKON RIVER

LSC C-2B

LSC C-42B

35709

NORTH KLONDIKE HIGHWAY YT HIGHWAY # 2

LSC C-11B

0189C

35807-C

134
58722

35807-B

115101-014A 115101-014

35807-A

LSC C-39B/D

1089C

LSC C-47FS

3089C

1000
65807

790001

41942

35737

830001

35731-B

35731-A

LSC C-4B

VILLAGE of CARMACKS
Map 4



Energy, Mines & Resources
Sustainable Development Division
Land Planning Branch

db June, 2010

LSC C-1B/D

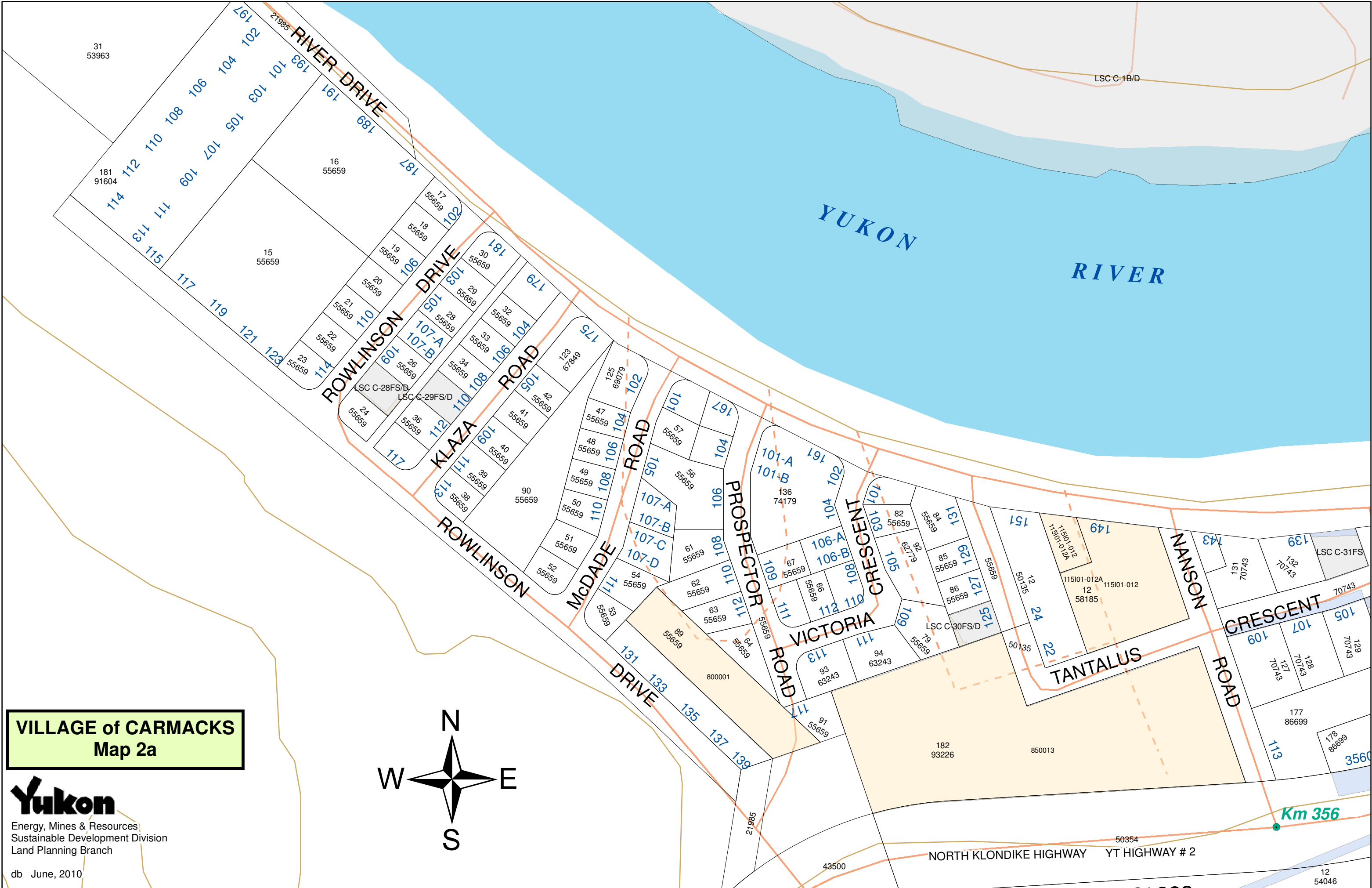

VILLAGE of CARMACKS
Map 2a

Yukon
Energy, Mines & Resources
Sustainable Development Division
Land Planning Branch

db June, 2010

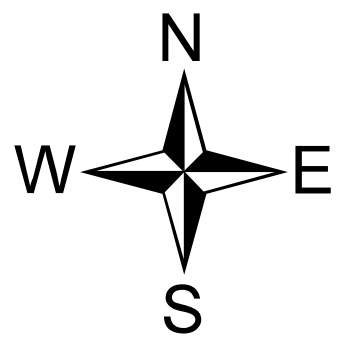

Km 356

NORTH KLONDIKE HIGHWAY YT HIGHWAY # 2

12
54046

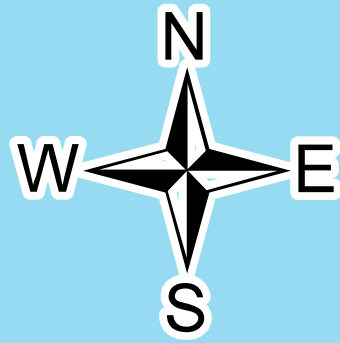

YUKON RIVER

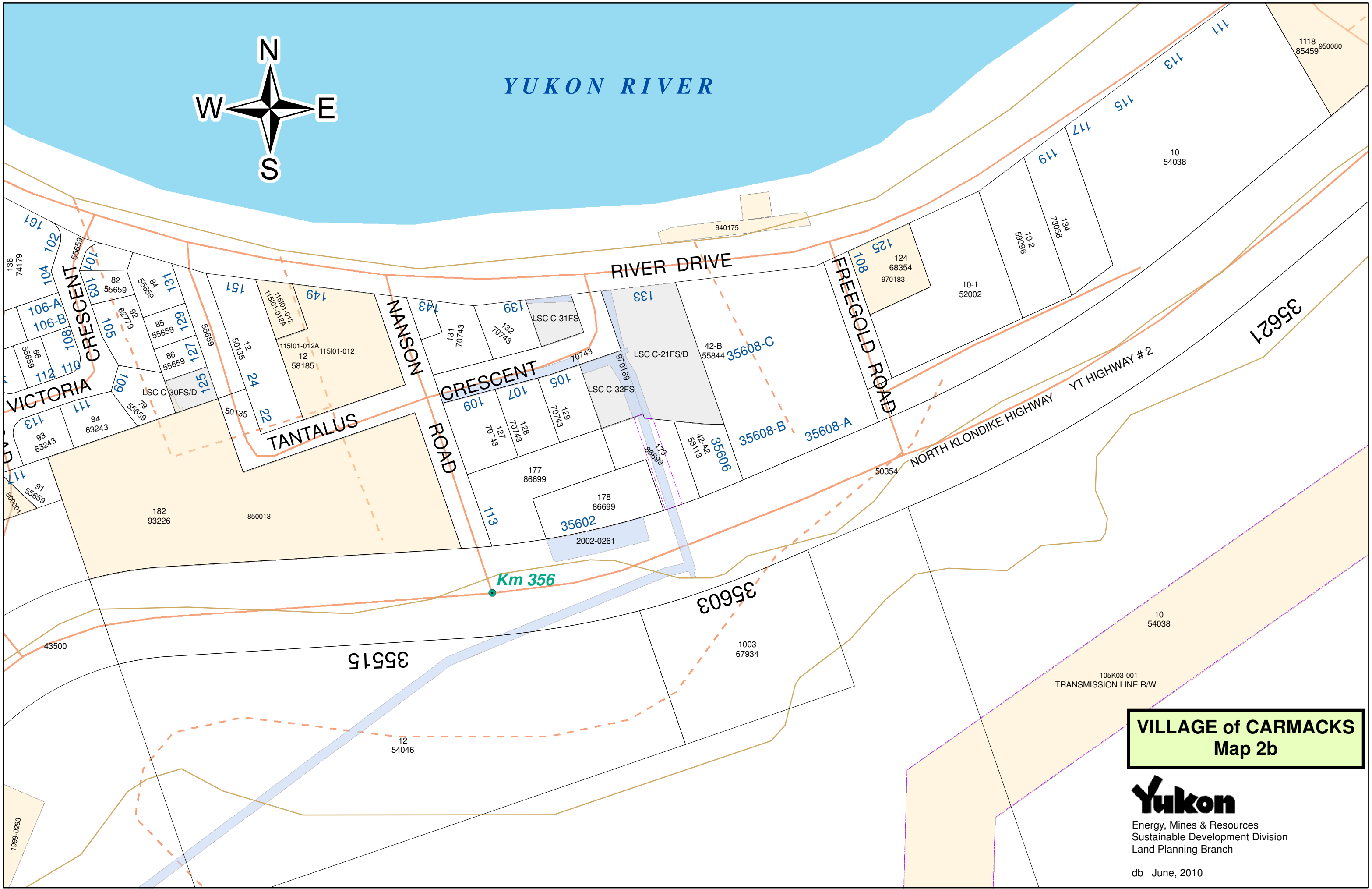

VILLAGE of CARMACKS
Map 2b

Yukon
Energy, Mines & Resources
Sustainable Development Division
Land Planning Branch

db June, 2010